

# HLS LED Series

Edge lit LED sign for  
hazardous locations

**RIG-A-LITE™**  
An Avail Infrastructure Solutions Company



## Classifications

- Class I, Division 2, Groups A, B, C & D
- Class II, Division 2, Groups F & G
- Class III
- UL1598A Marine Outside Type
- Temperature Class (T-Rating)-T6
- Patent No. 7,287,347
- IP65
- ETL Listed
- Build America, Buy America Act (BABA) Compliant
- Buy American Act (BAA) Compliant



[availinfra.com/rig-a-lite](http://availinfra.com/rig-a-lite)

8500 Hansen Road,  
Houston, TX 77075  
(713) 943-0340

# HLS LED Series

## Edge lit LED sign for hazardous locations

### Key Features

- 1 Emergency battery back-up integral to sign (no additional enclosure required)
- 2 3-hour emergency operation
- 3 Optional battery back-up self-diagnostic feature
- 4 Field replaceable LED circuit boards and drivers with quick disconnects
- 5 Edge-lit sign



### Additional Features

- Wall, pendant and end mounting options
- Custom colors and languages available
- Single- or double-sided option
- Sealed NiCad batteries
- Provided with three (3) 1/2" NPT hubs
- Red or green LED options

### Standard Materials

#### Body:

A356T6 Aluminum (less than .4% copper content)  
with baked-on gray epoxy finish

#### Gaskets:

One-piece Silicone

#### Sign:

Acrylic

#### Hardware:

Stainless Steel

# HLS LED Series

## Edge lit LED sign for hazardous locations

### Catalog Number Logic



#### 1

##### BASIC SERIES

Hazardous Location LED Sign Light\*  
\*Customer must specify sign color & legend  
Class I, Division 2 Groups A, B, C & D  
Class II, Division 2, Groups F & G  
Class III  
UL 1598A Marine Outside Type  
IP65  
ETL Listed  
Temperature Class (T-Rating)-T6

#### 2

##### NUMBER OF FACES

1 = Single Face  
2 = Double Face

#### 3

##### LEGEND COLOR

A = Amber  
B = Blue  
R = Red  
G = Green  
X = Other (Contact Factory)

#### 4

##### VOLTAGE/FREQUENCY

DT = 120/277V 60 HZ  
24 = 220-240V 50/60 HZ  
Other voltages available- consult factory.

#### 5

##### MOUNTING

WP = Wall/Pendant Mounting  
EB = End Bracket

#### 6

##### OPTIONS<sup>1</sup>

EM = Emergency Battery Backup  
X = Specify Legend (Cannot Say EXIT)

<sup>1</sup> Consult factory for pricing.

Catalog logic is for explaining catalog number structure only. Not all combinations are possible; consult factory for catalog numbers not listed in charts.

### Maximum Input Power

#### Red No Battery:

1.5 Watts

#### Red With Battery:

2.5 Watts

#### Green No Battery:

2.3 Watts

#### Green With Battery:

3.0 Watts

### Operating Temperature Range

#### Temperature Rating:

T6

#### Red Legend:

+10° C Minimum to +55° C Maximum

#### Green Legend:

+10° C Minimum to +40° C Maximum

# HLS LED Series

## Edge lit LED sign for hazardous locations

HLS Series Fixture Dimensions (inches)

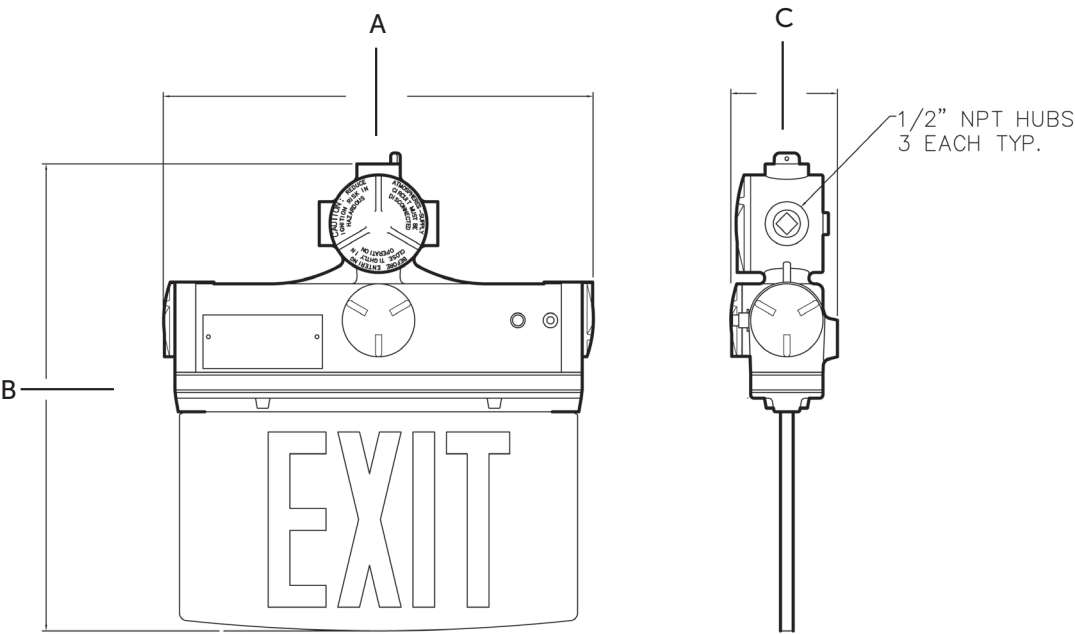

HLS Series	Dimensions (inches)			Boxed Weight	Shipping Volume
	A	B	C		
HLS LED Sign Light	14.88	3.69	16.00	14 lbs.	1.24 cu. ft.