

XP LED

Explosion proof linear
LED lighting

RIG-A-LITE™
An Avail Infrastructure Solutions Company



Classifications

- Class I, Division 1, Groups C & D
- Class I, Division 2, Groups C & D
- Class II, Division 1 & 2, Groups E, F & G
- Class III
- Class I, Zone 1, Groups IIA and IIB
- Class I, Zone 2, Groups IIA, IIB and IIC
- UL 844 Hazardous Locations
- UL 924 Emergency Lighting
- Simultaneous Presence
- UL 1598A Marine Outside Type
- UL 1598 Wet Locations
- NEMA 4X, 7CD & 9EFG
- CUL
- IP66
- UL 8750 LED Safety
- Paint Spray Booth
- Emergency Battery Backup
- 55°C Ambient Temperature
- Tested to LM 79 & LM 80
- Patent Pending

availinfra.com/rig-a-lite

8500 Hansen Road,
Houston, TX 77075
(713) 943-0340

XP LED

Explosion proof linear LED lighting

Key Features

- 1 Two permanent safety cable attachment points
- 2 Field replaceable LED circuit boards and drivers with quick disconnects
- 3 Convenient wiring access through screw-cap covers
- 4 Self-contained emergency battery back-up (optional)
- 5 Oversized, finned driver housing for greater heat dissipation
- 6 Factory Sealed

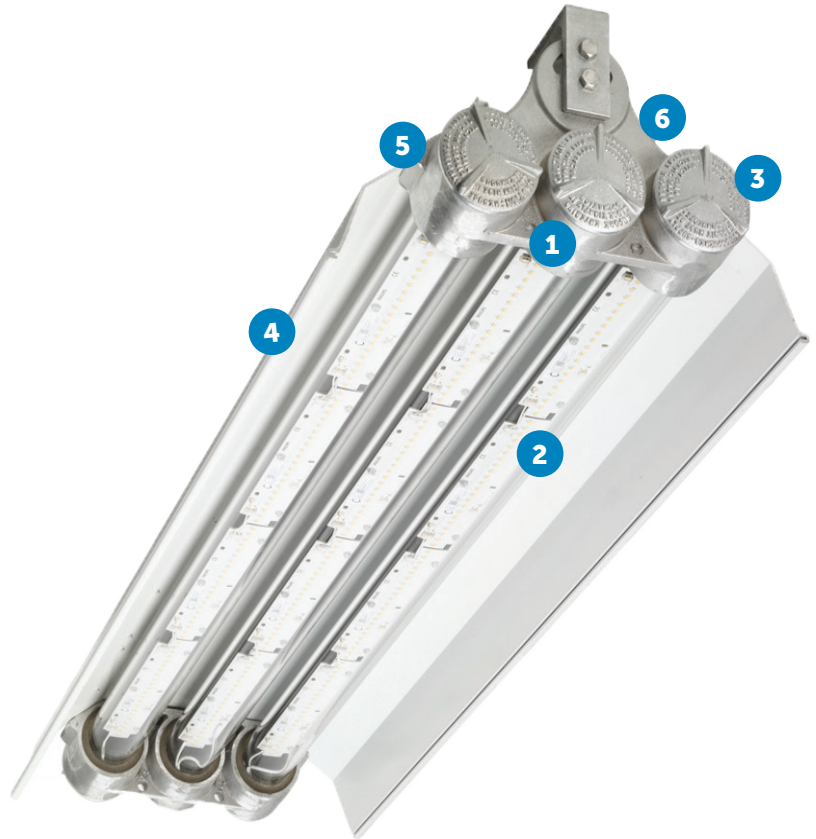

Additional Features

- Three mounting positions 45°/90°/45°, mounting bracket included
- Shock mount and beam clamp mounting options
- 2-, 3- or 4-tube versions available
- Dimming and outboard options
- 2.5 kV Surge protection
- 5-year warranty

Standard Materials

Body:

A361 aluminum (less than .4% copper content)

Reflector:

6063T5 aluminum (less than .4% copper content) with baked-on white epoxy finish

Lens:

Borosilicate Glass

Hardware:

Stainless Steel

XP LED

Explosion proof linear LED lighting

Catalog Number Logic

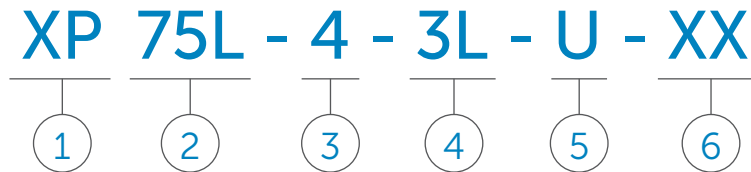

1 BASIC LUMINAIRE

XP LED
Class I, Division 1, Groups C & D
Class I, Division 2, Groups C & D
Class II, Division 1, Groups E, F & G
Class III
Simultaneous Presence
NEMA 4X, 7CD, 9EFG
UL 1598
UL 1598A
UL 844
UL 8750
UL 924
cUL
IP66
55°C Ambient Temperature
Class I, Zone 1, Groups IIA & IIB
Class I, Zone 2, Groups IIA, IIB & IIC
Suitable for Inside Paint Spray Booth
Patent Pending
Tested to LM 79 & LM 80

2 LAMP CURRENT/LAMP WATTAGE

30L = 16 Watt LED (2 ft. 2 tube)³
40L = 24 Watt LED (2 ft. 3 tube)⁴
50L = 31 Watt LED (4 ft. 2 tube)
55L = 30 Watt LED (2 ft. 2 tube)
75L = 56 Watt LED (4 ft. 3 tube)
80L = 50 Watt LED (4 ft. 2 tube)
100L = 73 Watt LED (4 ft. 3 tube)
(4 ft. 4 tube)
160L = 100 Watt LED (4 ft. 4 tube)

3 NOMINAL FIXTURE LENGTH

2 = 2 Foot
4 = 4 Foot

4 NUMBER OF LAMPS

2L = 2 Tubes
3L = 3 Tubes
4L = 4 Tubes

5 VOLTAGE/FREQUENCY

U = 120 thru 277V 50/60 HZ

6 OPTIONS¹

EM = Emergency Battery Backup
EMO = Emergency Operation Only⁵
D = Dimmable (0-10 Volt)
F = Inline Fuse (External)²
30 = 3000K (CCT)
50 = 5000K (CCT)

¹ Consult factory for pricing.

² Fuse option not available for marine listed fixtures.

³ 2 ft. two tube fixtures available with EMO option only.

⁴ EM or EMO option not available with 2 ft. 3 tube fixture

⁵ EMO option available for 2 ft. 2 tube fixture only.

Catalog logic is for explaining catalog number structure only. Not all combinations are possible; consult factory for catalog numbers not listed in charts.

XP LED

Explosion proof linear LED lighting

Two Tube XP

Certification Guide

Model	Length	Wattage	Operating Voltage	Total Lumens	Lumen per Watt	CRI	CCT	Ambient Temperature	Class I, Div. 1, Group C & D	Class II, Div. 1, Group E, F & G Class III	Simultaneous Presence	Supply Wire Suitable Temperature, °C	Hub Size	Shipping Weight (lbs)
XP30L22LU	2 ft	16W	120V - 277V 50/60HZ	2537	159	83	4000	-20°C < Tamb < 55°C	T6	T4A	T4A	75	1/2 in NPT	40
XP55L22LU	2 ft	30W	120V - 277V 50/60HZ	4650	155	83	4000	-20°C < Tamb < 55°C	T6	T4A	T4A	75	1/2 in NPT	40
XP50L42LU	4 ft	31W	120V - 277V 50/60HZ	5074	152	83.6	4083	-20°C < Tamb < 55°C	T6	T4A	T4A	75	1/2 in NPT	65
XP80L42LU	4 ft	50W	120V - 277V 50/60HZ	7525	149	83.4	4086	-20°C < Tamb < 55°C	T6	T4A	T4A	75	1/2 in NPT	65



Two Tube Fixture	Description	Hub Size (inches)	Voltage	Catalog Number
Four Foot	50 Watt LED- 48"	1/2	120-277V 50/60 HZ	XP80L-4-2L-U
Four Foot	31 Watt LED- 48"	1/2	120-277V 50/60 HZ	XP50L-4-2L-U
Two Foot	30 Watt LED- 24"	1/2	120-277V 50/60 HZ	XP55L-2-2L-U
Two Foot	16 Watt LED- 24"	1/2	120-277V 50/60 HZ	XP30L-2-2L-U

Fixture Dimensions (inches)

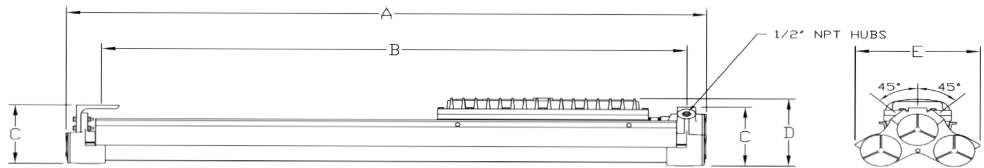

Candlepower Distribution

Deg.	Parl.	22.5	45	67.5	Norm
0	1701	1701	1701	1701	1701
10	1667	1679	1671	1682	1688
20	1607	1617	1610	1639	1630
30	1488	1492	1494	1503	1506
40	1301	1342	1325	1332	1320
50	1048	1072	1081	1103	1108
60	750	801	823	838	847
70	396	474	534	555	560
80	96	185	198	159	162
90	0	0	0	0	0

XP Series Two Tube Fixture	Dimensions (inches)					Boxed Weight	Shipping Volume
	A	B	C	D	E		
4 ft. models	53	48.5	6.5	7	11.5	65 lbs.	4.7 cu. ft.
2 ft. models	29	24.5	6.5	7	11.5	40 lbs.	3.1 cu. ft.

Add 5/8 inch to fixture height and 1/4 inch to width when wire guard is used.

Coefficients of Utilization XP50L-4-2L

% Effective Ceiling Cavity Reflectance rcc	80						70						50						30						10						0					
% Wall Reflectance rw	70	50	30	10	70	50	30	10	70	50	30	10	70	50	30	10	70	50	30	10	70	50	30	10	70	50	30	10	70	50	30	10	70	50	30	10
Room Cavity Ratio RCR	Effective Floor Cavity Reflectance 20%																																			
0	119	119	119	119	116	116	116	116	111	111	111	111	106	106	106	106	102	102	102	102	102	102	102	102	102	102	102	102	102	102	102	100				
1	109	104	100	96	106	102	98	94	97	94	91	93	91	88	90	88	86	84	84	84	84	84	84	84	84	84	84	84	84	84	84	84	84			
2	99	90	83	78	96	88	82	77	85	80	75	82	77	73	79	75	72	69	69	69	69	69	69	69	69	69	69	69	69	69	69	69	69			
3	90	79	71	64	87	78	70	64	75	68	63	72	66	61	69	64	60	58	58	58	58	58	58	58	58	58	58	58	58	58	58	58	58			
4	82	70	61	54	80	69	60	54	66	59	53	64	57	52	61	56	52	49	49	49	49	49	49	49	49	49	49	49	49	49	49	49	49			
5	75	62	53	46	73	61	53	46	59	51	46	57	50	45	55	49	45	43	43	43	43	43	43	43	43	43	43	43	43	43	43	43	43			
6	70	56	47	40	68	55	46	40	53	46	40	52	45	40	50	44	39	37	37	37	37	37	37	37	37	37	37	37	37	37	37	37	37			
7	64	51	42	36	63	50	41	35	48	41	35	47	40	35	45	39	35	33	33	33	33	33	33	33	33	33	33	33	33	33	33	33	33			
8	60	46	38	32	58	45	37	32	44	37	31	43	36	31	42	36	31	29	29	29	29	29	29	29	29	29	29	29	29	29	29	29	29			
9	56	42	34	28	54	42	34	28	41	33	28	39	33	28	38	32	28	26	26	26	26	26	26	26	26	26	26	26	26	26	26	26	26			
10	52	39	31	26	51	38	31	26	37	30	26	37	30	25	36	30	25	24	24	24	24	24	24	24	24	24	24	24	24	24	24	24	24			

LED Photometrics

(XP50L42LUX)

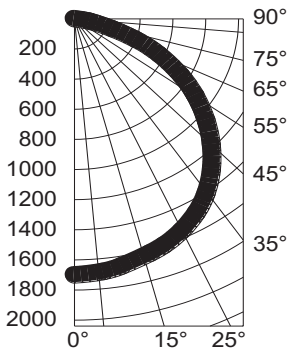

XP LED

Explosion proof linear LED lighting

Three Tube XP Certification Guide

Model	Length	Wattage	Operating Voltage	Total Lumens	Lumen per Watt	CRI	CCT	Ambient Temperature	Class I, Div. 1, Group C & D	Class II, Div. 1, Group E, F & G Class III	Simultaneous Presence	Supply Wire Suitable Temperature, °C	Hub Size	Shipping Weight (lbs)
XP40L23LU	2 ft	24	120V - 277V 50/60HZ	3720	155	83	4000	-20°C < Tamb < 55°C	T6	T5	T5	75	3/4 in NPT	47
XP75L43LU	4 ft	56	120V - 277V 50/60HZ	8771	156	83.8	3973	-20°C < Tamb < 55°C	T6	T5	T5	75	3/4 in NPT	78
XP100L43LU	4 ft	73	120V - 277V 50/60HZ	11230	153	83.7	3971	-20°C < Tamb < 55°C	T6	T5	T5	75	3/4 in NPT	78



Three Tube Fixture	Description	Hub Size (inches)	Voltage	Catalog Number
Four Foot	73 Watt LED- 48"	3/4	120-277V 50/60 HZ	XP100L-4-3L-U
Four Foot	56 Watt LED- 48"	3/4	120-277V 50/60 HZ	XP75L-4-3L-U
Two Foot	24 Watt LED- 24"	3/4	120-277V 50/60 HZ	XP40L-2-3L-U

Fixture Dimensions (inches)

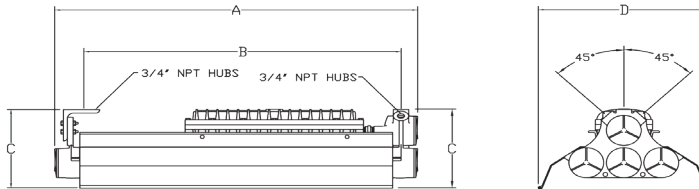

Candlepower Distribution

Deg.	Parl.	22.5	45	67.5	Norm
0	3110	3110	3110	3110	3110
10	3086	3081	3067	3071	3057
20	2970	2969	2949	2945	2932
30	2764	2756	2728	2715	2708
40	2451	2432	2391	2369	2361
50	2021	1995	1941	1909	1900
60	1481	1439	1374	1322	1304
70	832	782	715	637	561
80	233	189	127	81	77
90	0	0	0	0	0

XP Series Three Tube Fixture	Dimensions (inches)				Boxed Weight	Shipping Volume
	A	B	C	D		
4 ft. models	53	48.5	8.94	16.63	78 lbs.	10.5 cu. ft.
2 ft. models	29	24.5	8.94	16.63	47 lbs.	5.5 cu. ft.

Add 5/8 inch to fixture height and 1/4 inch to width when wire guard is used.

Coefficients of Utilization XP75L-4-3L

% Effective Ceiling Cavity Reflectance rcc	80				70				50				30				10				0											
% Wall Reflectance rw	70	50	30	10	70	50	30	10	70	50	30	10	70	50	30	10	70	50	30	10	70	50	30	10	70	50	30	10	70	50	30	10
Room Cavity Ratio RCR	Effective Floor Cavity Reflectance 20%																															
0	119	119	119	119	116	116	116	116	111	111	111	111	106	106	106	102	102	102	102	100	100	100	100	100	100	100	100	100	100			
1	110	105	101	98	107	103	99	96	99	96	93	95	92	90	91	89	88	86	86	86	86	86	86	86	86	86	86	86	86	86		
2	100	92	86	80	97	90	84	79	87	82	77	84	79	76	81	77	74	72	72	72	72	72	72	72	72	72	72	72	72	72		
3	91	81	73	67	89	80	72	66	77	70	65	74	69	64	71	67	63	61	61	61	61	61	61	61	61	61	61	61	61	61		
4	84	72	63	57	81	71	63	56	68	61	56	66	60	55	64	58	54	52	52	52	52	52	52	52	52	52	52	52	52	52		
5	77	64	55	49	75	63	55	49	61	54	48	59	53	48	57	52	47	45	45	45	45	45	45	45	45	45	45	45	45	45		
6	71	58	49	43	69	57	48	42	55	48	42	53	47	42	52	46	41	39	39	39	39	39	39	39	39	39	39	39	39	39		
7	66	52	44	38	64	52	43	37	50	43	37	49	42	37	47	41	37	35	35	35	35	35	35	35	35	35	35	35	35	35		
8	61	48	39	33	60	47	39	33	46	38	33	44	38	33	43	37	33	31	31	31	31	31	31	31	31	31	31	31	31	31		
9	57	44	36	30	56	43	35	30	42	35	30	41	34	30	40	34	30	28	28	28	28	28	28	28	28	28	28	28	28	28		
10	53	40	32	27	52	40	32	27	39	32	27	38	31	27	37	31	27	25	25	25	25	25	25	25	25	25	25	25	25	25		

LED Photometrics (XP75L43LUX)

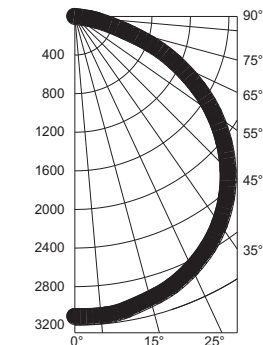

XP LED

Explosion proof linear LED lighting

Four Tube XP

Certification Guide

Model	Length	Wattage	Operating Voltage	Total Lumens	Lumen per Watt	CRI	CCT	Ambient Temperature	Class I, Div. 1, Group C & D	Class II, Div. 1, Group E, F & G Class III	Simultaneous Presence	Supply Wire Suitable Temperature, °C	Hub Size	Shipping Weight (lbs)
XP100L44LU	4 ft	73	120V - 277V 50/60HZ	11410	157	83.7	3965	-20°C < Tamb < 55°C	T6	T4A	T4A	75	3/4 in NPT	138
XP160L44LU	4 ft	100	120V - 277V 50/60HZ	15790	158	83.6	3973	-20°C < Tamb < 55°C	T6	T4A	T4A	75	3/4 in NPT	138



Four Tube Fixture	Description	Hub Size (inches)	Voltage	Catalog Number
Four Foot	100 Watt LED- 48"	3/4	120-277V 50/60 HZ	XP160L-4-4L-U
Four Foot	73 Watt LED- 48"	3/4	120-277V 50/60 HZ	XP100L-4-4L-U

Fixture Dimensions (inches)

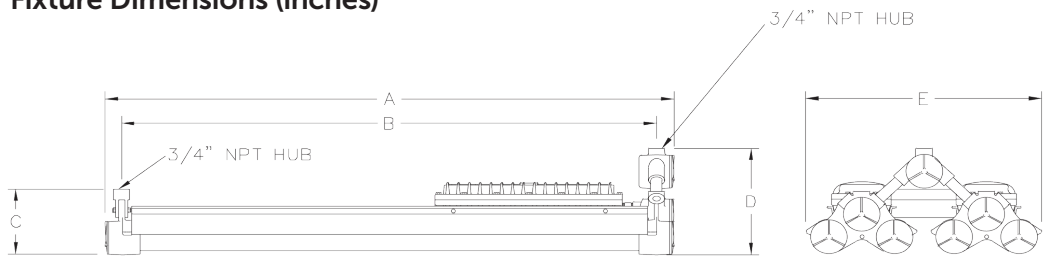

Candlepower Distribution

Deg.	Parl.	22.5	45	67.5	Norm
0	4002	4002	4002	4002	4002
10	3949	3947	3944	3944	3949
20	3779	3778	3773	3772	3774
30	3496	3492	3489	3480	3478
40	3083	3082	3070	3051	3043
50	2540	2543	2505	2465	2448
60	1851	1848	1772	1710	1681
70	1026	998	901	842	823
80	285	240	203	183	172
90	0	0	0	0	0

XP Series Four Tube Fixture	Dimensions (inches)					Boxed Weight	Shipping Volume
	A	B	C	D	E		
4 ft. models	53	49.4	6.8	11.3	23.2	138 lbs.	10.8 cu. ft.

Coefficients of Utilization XP100L-4-4L

% Effective Ceiling Cavity Reflectance rcc	80					70					50					30					10					0						
% Wall Reflectance rw	70	50	30	10	70	50	30	10	70	50	30	10	70	50	30	10	70	50	30	10	70	50	30	10	70	50	30	10	70	50	30	10
Room Cavity Ratio RCR	Effective Floor Cavity Reflectance 20%																															
0	119	119	119	119	116	116	116	116	111	111	111	111	106	106	106	102	102	102	102	100	100	100	100	100	100	100	100	100	100	100		
1	110	105	101	97	107	103	99	96	99	96	93	95	92	90	91	89	87	85	85	85	85	85	85	85	85	85	85	85	85	85	85	
2	100	92	85	80	97	90	84	79	87	82	77	83	79	75	80	77	74	72	72	72	72	72	72	72	72	72	72	72	72	72	72	
3	91	81	73	67	89	79	72	66	76	70	65	74	68	64	71	67	63	61	61	61	61	61	61	61	61	61	61	61	61	61	61	
4	83	72	63	57	81	70	62	56	68	61	55	66	60	55	63	58	54	52	52	52	52	52	52	52	52	52	52	52	52	52	52	
5	77	64	55	49	75	63	55	48	61	54	48	59	52	47	57	51	47	45	45	45	45	45	45	45	45	45	45	45	45	45	45	
6	71	58	49	42	69	57	48	42	55	47	42	53	47	42	52	46	41	39	39	39	39	39	39	39	39	39	39	39	39	39	39	
7	66	52	44	37	64	51	43	37	50	42	37	48	42	37	47	41	36	34	34	34	34	34	34	34	34	34	34	34	34	34	34	
8	61	48	39	33	59	47	39	33	46	38	33	44	38	33	43	37	33	31	31	31	31	31	31	31	31	31	31	31	31	31	31	
9	57	44	35	30	56	43	35	30	42	35	30	41	34	30	40	34	29	28	28	28	28	28	28	28	28	28	28	28	28	28	28	
10	53	40	32	27	52	40	32	27	39	32	27	38	31	27	37	31	27	25	25	25	25	25	25	25	25	25	25	25	25	25	25	

LED Photometrics (XP100L44LUX)

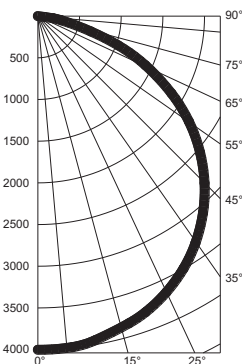

XP LED

Explosion proof linear LED lighting

Accessories

Stainless Steel Guards

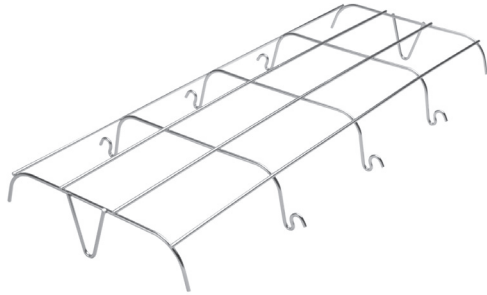

Description	Catalog Number
2-Lamp 2-Ft. Fixtures	86321
2-Lamp 4-Ft. Fixtures	86320
3-Lamp 4-Ft. Fixtures	86345

Four Lamp Fixtures Require Two Cat. #86320 Guards

Polycarbonate Shields

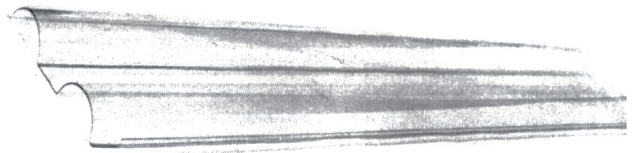

Description	Catalog Number
3-Lamp 2-Ft. Fixtures	86000
2-Lamp 2-Ft. Fixtures	86001
2-Lamp 4-Ft. Fixtures	86002
3-Lamp 4-Ft. Fixtures	86003*

Four Lamp Fixtures Require Two Cat. #86002 Shields.
*One 86345 guard required.

Wall/Ceiling Mounting Kit



Catalog Number: 53041 (For 2-lamp fixtures only)
Shipping Weight: 5 lbs.

Shock Mounting Kit



Catalog Number: 53036 (For 2-lamp fixtures only)
Shipping Weight: 5 lbs.

Drop Mounting Kit



Catalog Number: 53037 (For 2-lamp fixtures only)
Shipping Weight: 5 lbs.

Beam Mounting Kit

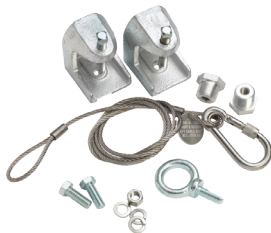

Catalog Number: 53035 (For 2-lamp fixtures only)
Shipping Weight: 5 lbs.

Unistrut Mounting Kit

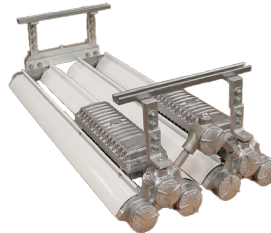

Catalog Number: 53047 (For 4-lamp fixtures only)
Shipping Weight: 5 lbs.

XP LED

Explosion proof linear LED lighting

Typical Installations

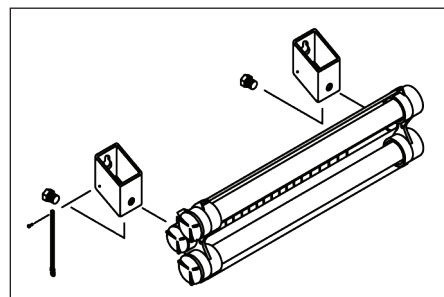
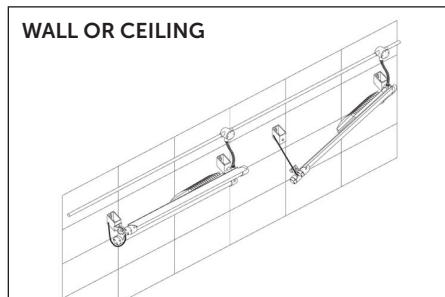
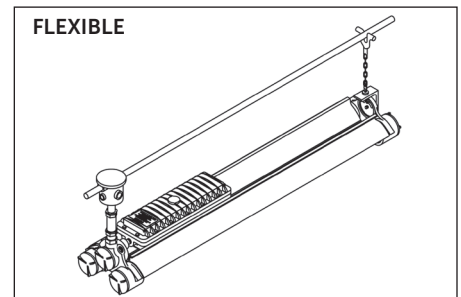
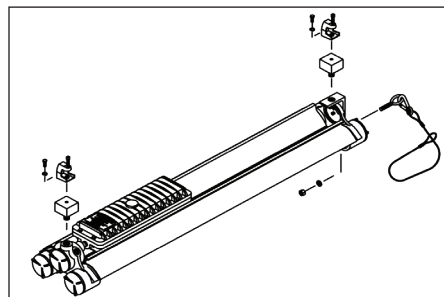
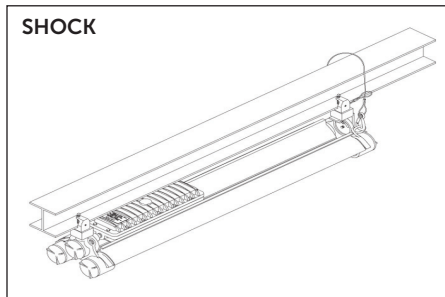
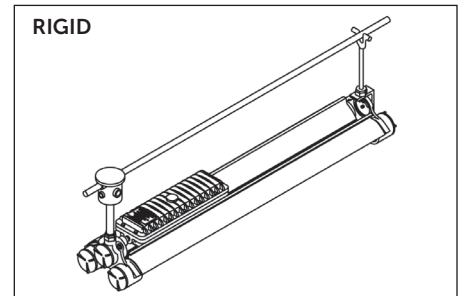
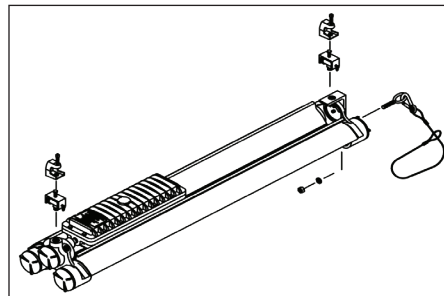
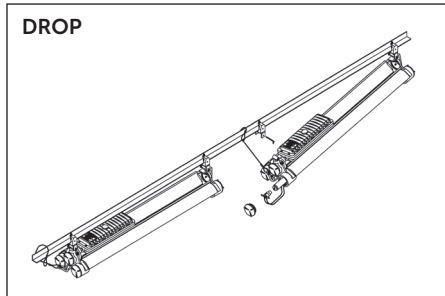
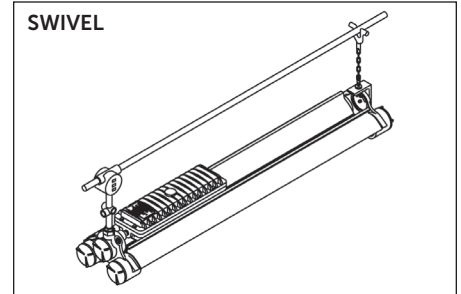
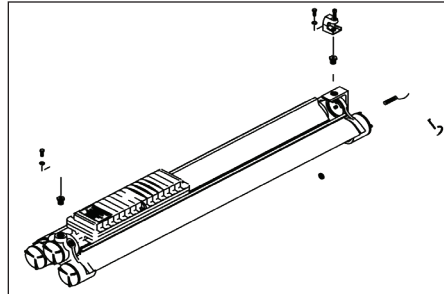
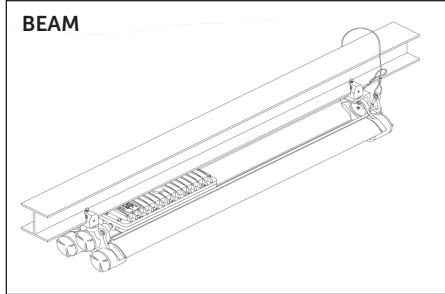

availinfra.com/rig-a-lite

8500 Hansen Road,
Houston, TX 77075
(713) 943-0340