

XPEL LED Series

Explosion proof LED
emergency light

RIG-A-LITE™
An Avail Infrastructure Solutions Company



Classifications

- Class I, Division 1, Groups C & D
- Class II, Division 1, Groups E, F & G
- Class III
- Class I, Zone 1, Groups IIA, IIB
- UL 844, 1598, 8750 & 924
- UL 1598A Marine Outside Type (Salt Water)
- USCG Regulation 46 CFR Subparts 111.75-15 (e) & 112.43
- CUL
- IP65
- NEMA 4X
- Suitable for Wet Locations
- Patent Pending

availinfra.com/rig-a-lite

8500 Hansen Road,
Houston, TX 77075
(713) 943-0340

XPEL LED Series

Explosion proof LED emergency light

Key Features

- 1 High lumen spot lights (2) can be adjusted in horizontal and vertical planes
- 2 Unit can power up to 2 (optional) remote spot lights
- 3 Field replaceable LED circuit boards and drivers with quick disconnects
- 4 Emergency battery back-up integral to luminaire (no additional enclosure required)
- 5 3-hour emergency operation

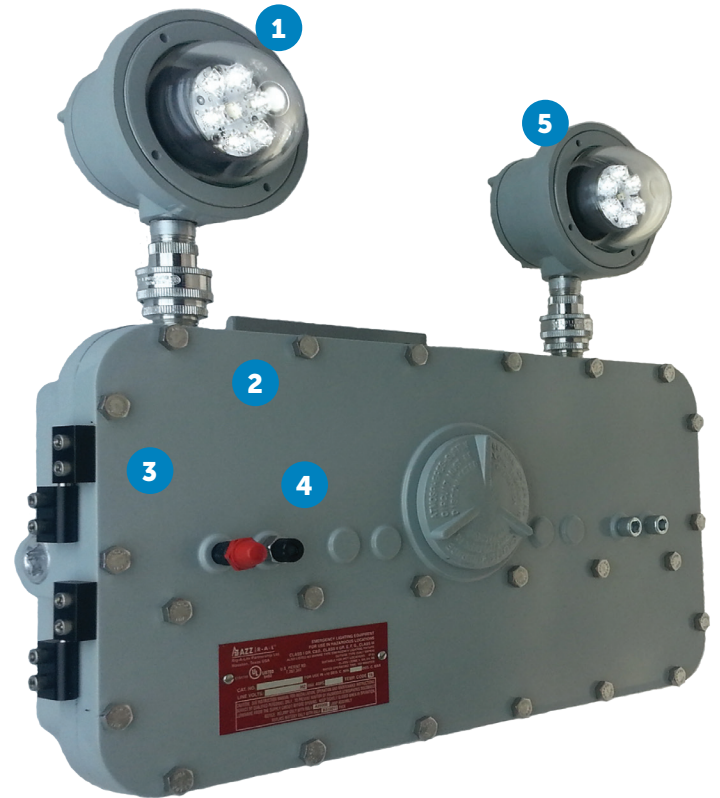

Additional Features

- Wall, pendant and end mounting options
- Captive hinged-access door
- Wide- and narrow-beam optics available
- Separate push-to-test and pilot light for local and remote heads
- Provided with three (3) 1" NPT hubs

Standard Materials

Body:

A360 aluminum (less than .4% copper content)
with baked-on gray epoxy finish

Gasket:

One-Piece Neoprene

Hardware:

Stainless Steel

XPEL LED Series

Explosion proof LED emergency light

Catalog Number Logic

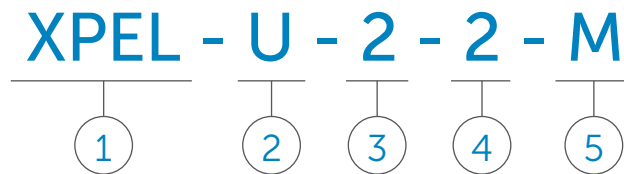

1

BASIC SERIES

XPEL
Class I, Division 1, Groups C & D
Class II, Division 1, Groups E, F & G
Class III
Class I, Zone 1, Groups IIA, IIB,
UL 844, 1598, 8750 & 924
UL 1598A Marine Outside Type
(Salt Water)
USCG Regulation 46 Sub Part
111.75-15(e) & 112.43
CUL
IP65
NEMA 4X
Suitable for Wet Locations

2

VOLTAGE / FREQUENCY

U = 120 thru 277V 50/60HZ

3

INSTALLED HEADS

0 = None
1 = One
2 = Two

4

REMOTE HEADS¹

0 = None
1 = One
2 = Two
3 = Three
4 = Four

Combinations Available		
Installed	Remote	Drivers
2	0	1
1	1	1
0	2	1
2	2	2
1	3	2
0	4	2

5

OPTIONS²

M = Medium Beam Optics (STANDARD)
W = Wide Beam Optics

¹XPEL Series emergency lights with remote head option are provided with extra LED driver. Remote heads can only be wired to the emergency fixtures with remote head option. LED heads are furnished with 1/2"-14 NPT male hub, must be installed on suitably listed explosion proof junction box not provided by RAL.

²Consult factory for pricing.

Catalog logic is for explaining catalog number structure only. Not all combinations are possible; consult factory for catalog numbers not listed in charts.

Maximum Input Power

XPEL Emergency Light with:
2 LED heads - 4 W
4 LED heads - 8 W

Maximum Output Power

Each Remote Head:
Voltage: 22V DC. max.
Current: 0.225 A (225mA)
Max. Power: 5 W

Certification Guide

XPEL Series Emergency Light	Ambient Temperature Range	Class I, Division 1 Groups C & D	Class II, Division 1 Groups E, F & G Class III	Simultaneous Presence Class I & II	UL 1598A Marine	CUL
XPEL	+10° C to +45° C	T6	T6	T6	Yes	Yes

XPEL LED Series

Explosion proof LED emergency light

Photometric Data

XPEL LED head with medium beam optics:

Total Lumens per Head	420.78
Output Power per Head	4.83
Efficacy (Lumens/Watts)	87.12
CRI	72
CCT	5672

Average Initial Footcandles at the Floor	1.49
Maximum Initial Footcandles at the Floor	2.80
Minimum Initial Footcandles at the Floor	0.50
Maximum to Minimum Ratio	5.60

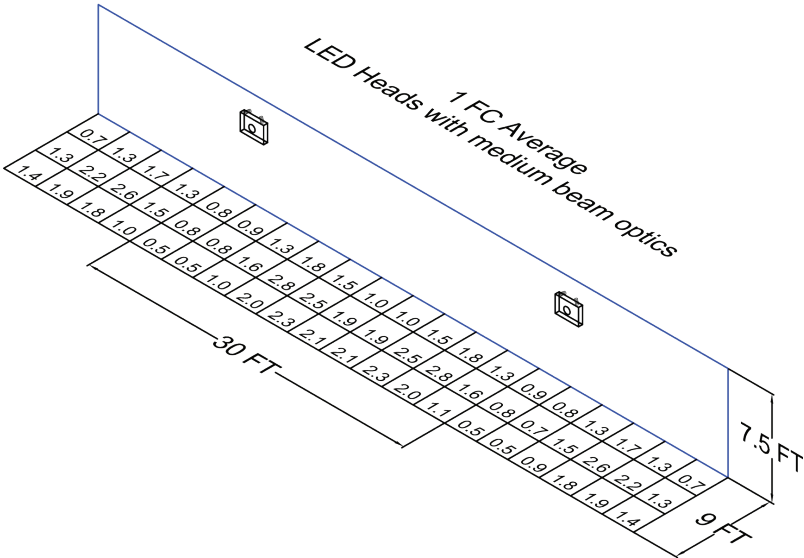

XPEL Series Fixture Dimensions (inches)

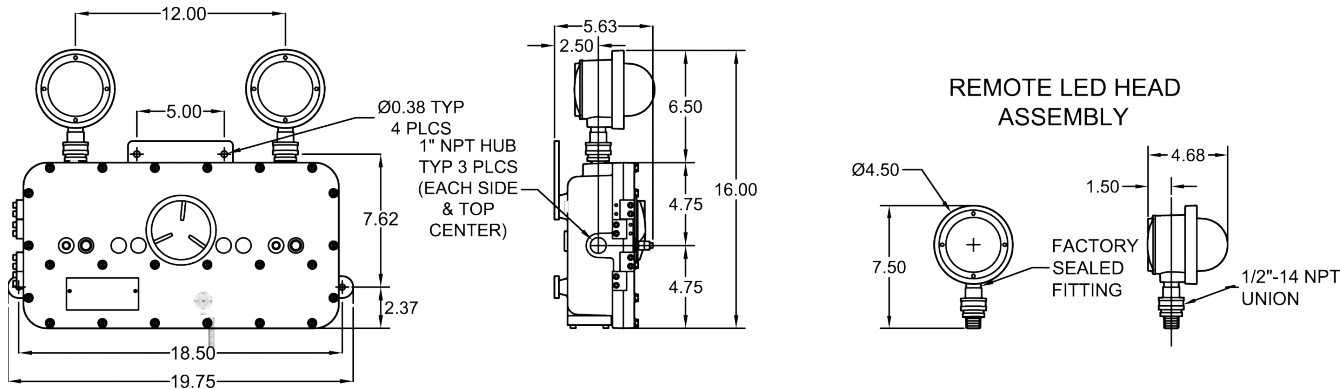

XPEL SERIES	Shipping Weight	Shipping Volume
Emergency Light	35.0 lbs.	2.2 cu. ft.
Emergency Light with Remote Heads Option*	38.0 lbs.	2.2 cu. ft.
Remote Head Assembly	3.5 lbs.	0.27 cu. ft.

* Remote Head Assemblies are shipped separately.
(Additional weight of the emergency light is due to extra driver for remote heads.)



availinfra.com/rig-a-lite

8500 Hansen Road,
Houston, TX 77075
(713) 943-0340