

INSTALLATION DATA SHEET

XPEH LED EMERGENCY SERIES

EMERGENCY LED EXIT SIGN LIGHTING EQUIPMENT FOR USE IN HAZARDOUS LOCATIONS

Class I, Division 1&2, Groups C & D, Class II, Division 1, Groups E, F & G, Class III

WARNING!

READ AND FOLLOW ALL SAFETY INSTRUCTIONS BEFORE INSTALLING THIS LUMINAIRE

This luminaire should be installed in strict accordance with the National Electrical Code and any local requirements.

1. This luminaire should be mounted in locations and at heights where it will not be subjected to tampering by unauthorized personnel.
2. All maintenance procedures are to be performed only when the atmosphere surrounding the luminaire is non-hazardous.
3. To prevent the ignition of hazardous atmospheres, disconnect the luminaire from the supply circuit before opening. Keep tightly closed when in operation. This luminaire has more than one power supply connection. When AC power is disconnected, the emergency driver output will be live.
4. To prevent high voltage from being present on the Emergency Drivers output leads, do not join the battery connectors until installation is complete and AC power is supplied to the luminaire.
5. To reduce the risk of ignition of hazardous atmospheres, conduit runs must have a sealing fitting connected within 18 inches of the enclosure.
6. To reduce the risk of electrical shock, disconnect both normal and emergency power supplies and battery connector (located inside the junction box) before servicing.
7. Emergency drivers inside this luminaire requires an unswitched AC power source of voltage specified on nameplate.
8. Do not mount near gas or electrical heaters.
9. Do not attempt to service the batteries inside the Emergency Drivers of this luminaire. The Emergency drivers incorporates sealed, maintenance-free batteries that are not field replaceable.
10. The use of accessory equipment not recommended by Rig-A-Lite may cause unsafe conditions.
11. Do not use this equipment for other than intended use.
12. Installation and servicing of this luminaire should be performed by qualified personnel.

SAVE THESE INSTRUCTIONS



8500 Hansen Rd.
Houston, TX 77075 USA
XPEHIDS

Tel: 713-943-0340

Oct 2022

availinfra.com/rig-a-lite/

Rev. 3

INSTALLATION DATA SHEET

INSTALLATION:

Note: Before installing this luminaire, make sure that the necessary branch circuit wiring is available. The Emergency drivers in this luminaire requires an unswitched source of power and must be fed from the same branch circuit as the AC driver; therefore, the Emergency Drivers must be connected ahead of any local switching (See wiring diagrams).

1. This unit is furnished completely assembled. Before installing, check the luminaire label to ensure correct voltage and frequency.
2. This luminaire is fitted with multiple emergency drivers. For the EXIT sign, the battery (Model B310011) is located in the bottom compartment of the main housing. For the Local LED heads, the driver (Bodine BSL310-CAN) is located in the upper compartment of the main housing. For models with local and remote LED heads, the upper compartment have TWO (BSL310-CAN) Emergency drivers stacked on top of each other. The local LED heads are wired to the lower driver and the remote LED heads are wired to the upper emergency driver.
3. The Emergency drivers have a battery disconnect that needs to be connected while in service.

Surface Mount

1. Install Mount Plates to the back of the luminaire by means of two each ¼-20 Flat Head screw provided. Flat Head screw must be securely fastened. Install the luminaire to the wall by means of the mount plates using 5/16 in. Bolts (not provided).
2. Attach conduit to any of the three ¾" NPT hubs on the fixture, making sure that at least five full threads are engaged and conduit is tight as per the requirements of the NEC.
3. Remove junction box cover (Screw Cap) and pull supply wires into terminal block. Attach Black lead for 120V or Orange lead for 277V, White lead for Neutral and Green lead for Ground. For 220V/240V models, the brown lead is the Hot and the Blue Lead is Neutral. Replace junction box cover.

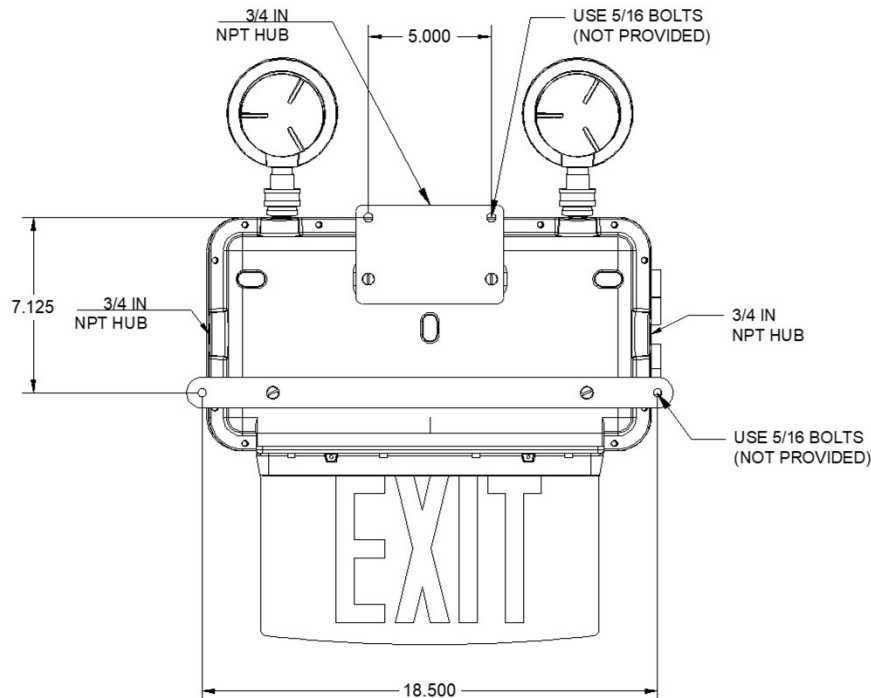

8500 Hansen Rd.
Houston, TX 77075 USA
XPEHIDS

Tel: 713-943-0340

Oct 2022

availinfra.com/rig-a-lite/

Rev. 3

INSTALLATION DATA SHEET

FIELD INSTALLED DIRECTIONAL INDICATORS (CHEVRONS):

1. Directional Indicators (chevrons) are supplied with the sign. The chevrons are supplied with an alignment template, chevrons (qty 2 or 4) and a tool for field installation. The appropriate chevron will be supplied based on the ordered configuration.
2. Prior to installation of the chevrons, make sure the sign is clean with no dust particles in the application area. To install the chevron(s) on a single face sign, temporarily adhere the alignment template's tacky surface to the back (printed) side of the Legend panel – *Figure 1*.
3. Remove the adhesive backing from the chevron(s) and adhere to the panel in the location determined by the template - *Figure 2*.
4. The white backing of the legend should correspond with the white backing of the chevron. Lay the tool provided on its side and perpendicular to the chevron – *Figure 4*.
5. Apply even pressure and push any air bubbles to the edge of the chevron starting from the middle to the top.
6. Repeat this process for the bottom half also.
7. For signs which consist of two panels (**doubleface**) use the alignment template (*Figure 1*) to determine the location of the chevron(s) - *Figure 3*. Use the tool provided to remove any air bubbles - *Figure 4*.

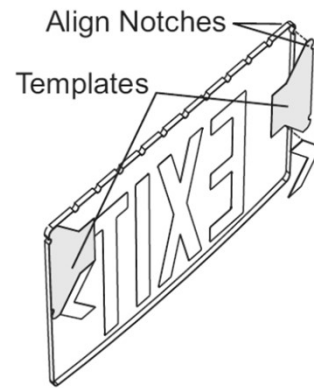

Figure 1

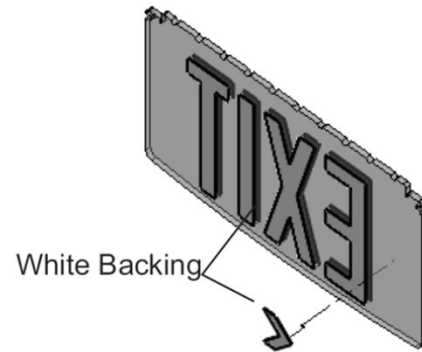

Figure 2

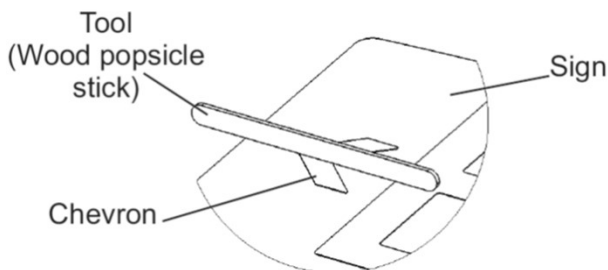

Figure 4

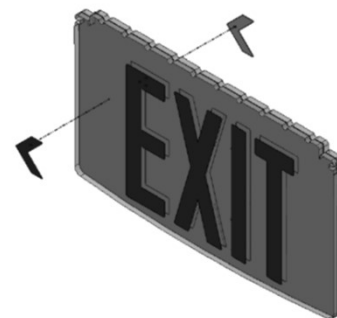

Figure 3



8500 Hansen Rd.
Houston, TX 77075 USA
XPEHIDS

Tel: 713-943-0340

Oct 2022

availinfra.com/rig-a-lite/

Rev. 3

INSTALLATION DATA SHEET

OPERATIONAL DATA:

1. Operate this luminaire at its rated voltage. See the luminaire label for data.
2. The AC driver in this luminaire is designed to operate on Grounded Neutral Systems only. For Line Systems with neither of the lines at ground potential, specially designed drivers are required.
3. When the AC power is applied, the charge indicator lights are illuminated, indicating that the batteries are being charged.
4. When the power fails, the Emergency Drivers within this luminaire are switched to emergency power, operating the Emergency LED modules at reduced illumination for at least 180 minutes for the RED EXIT sign and at least ____ minutes for the GREEN EXIT sign.

MAINTENANCE DATA:

All maintenance procedures are to be performed only when the atmosphere surrounding the luminaire is non-hazardous. The emergency drivers have battery disconnect that must be connected while in service and disconnected while working with the wiring.

1. Although no routine maintenance is required to keep this luminaire functional, it should be checked periodically to ensure it is working properly, and to look for any external damage. The following schedule is recommended:
 - a. Visually inspect the charging indicator lights monthly. They should be illuminated.
 - b. Test the emergency operation of the luminaire once every 3 months.
 - c. Once a year, conduct a 180 minute discharge test for the RED EXIT sign and/or a ____ minute discharge test for the GREEN EXIT sign. The Emergency LED modules and EXIT sign should operate for its specified time.
2. Replace batteries only with RAL part # B310011 and # BSL310-CAN.
3. This fixture contains sealed Ni-Cad batteries. Used Ni-Cad batteries may not be disposed of in the municipal solid waste stream. Ni-Cad batteries must be recycled or disposed of properly. For information on local recycling drop off points.
4. For optimum performance, keep the light transmission portions of the luminaire clean.

REPLACEMENT PARTS:

Refer to Rig-A-Lite's website or contact your nearest Rig-A-Lite distributor for information.

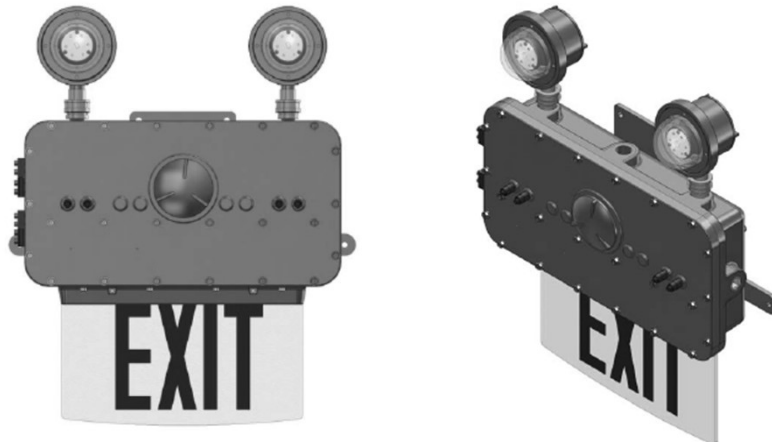

8500 Hansen Rd.
Houston, TX 77075 USA
XPEHIDS

Tel: 713-943-0340

Oct 2022

availinfra.com/rig-a-lite/

Rev. 3

INSTALLATION DATA SHEET

LAMP HEAD LED BOARD REPLACEMENT:

1. Turn off the power to the luminaire .
2. Remove the (24) screws on the front access cover, swing it open and disconnect the battery connectors that are contained inside the luminaire.
3. Remove the screw cap from the lamp head to be replaced.
4. Remove the (4) four screws holding the LED mount and carefully remove the assembly out of the head.
5. Remove the (4) four screws holding the LED board to its mount, lift and unplug the wire connector from the LED board.
6. Connect the new LED board and install in the mount using the four screws.
7. Install the mount into the lamp head enclosure and secure with (4) screws.
8. Replace the screw cap cover.
9. Re-Connect the battery connectors and close the front access cover.
10. Turn the power on.



EXIT SIGN LED BOARD REPLACEMENT:

1. Turn off the power to the luminaire .
2. Remove the (24) screws on the front access cover, swing it open and disconnect the battery or batteries that are contained inside the luminaire.
3. Remove the battery located on the lower compartment, attached to the Exit Sign LED board.
4. Remove the wire connector from the transformer to the LED board.
5. Remove the (3) screws securing the Exit Sign LED Board assembly to the enclosure and pull the assembly out of the enclosure.
6. Remove the (2) two bolt and nuts securing the LED board to the bracket and replace with the new LED board.
7. Reverse procedure to re-install.



8500 Hansen Rd.
Houston, TX 77075 USA
XPEHIDS

Tel: 713-943-0340

Oct 2022

availinfra.com/rig-a-lite/

Rev. 3

INSTALLATION DATA SHEET

LAMP HEAD BATTERY PACK REPLACEMENT:

(Lamp heads are powered by Bodine battery pack BSL-310CAN, Ni-Cad batteries inside the battery pack are not replaceable. When it is necessary, replace the battery pack).

1. Turn off the power to the luminaire .
2. Remove the (24) screws on the front access cover, swing it open and disconnect the battery connectors that are contained inside the luminaire.
3. Remove the wire harness from the battery pack.
4. Remove the (2) screws hold the battery pack to the enclosure.
5. If more than one battery pack is installed in the enclosure, please identify the one to be replaced.
6. When two battery packs are installed, the mounting bracket must be removed to access the bottom unit.
7. Install new Bodine BSL-310CAN battery packs in place and mounting bracket if applicable.
8. Re-Connect the battery connectors and close the front access cover.
9. Turn the power on.

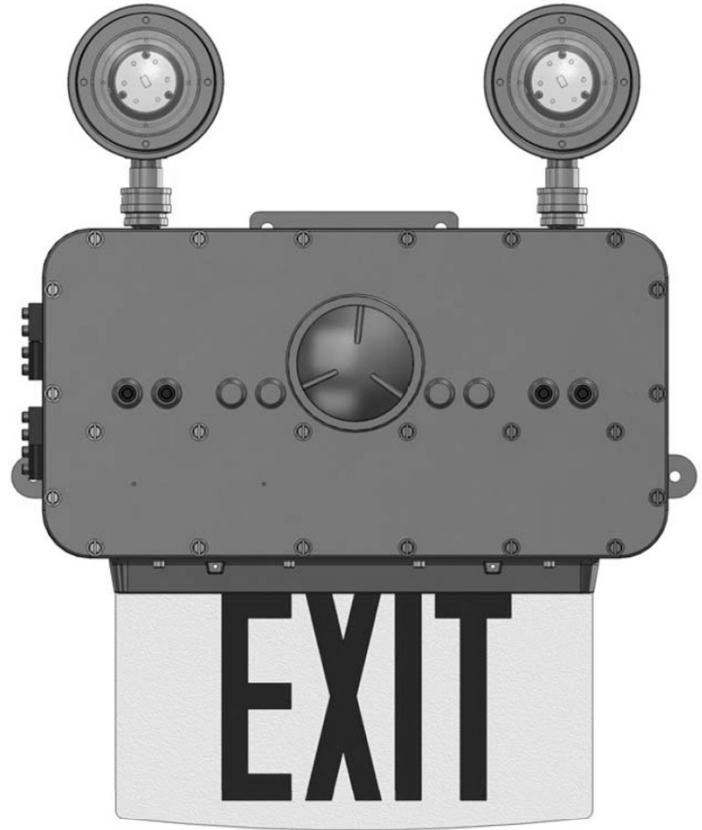

EXIT SIGN BATTERY PACK REPLACEMENT:

1. Turn off the power to the luminaire .
2. Remove the (24) screws on the front access cover, swing it open and disconnect the battery or batteries that are contained inside the luminaire.
3. Remove the exit sign battery pack located on the lower compartment, attached to the Exit Sign LED board.
4. Attach connector of new battery to the LED board.
5. Attach the B310011 battery pack onto the LED board.
6. Connect other battery connectors.
7. Re-install access cover and screws.
8. Turn on the power.

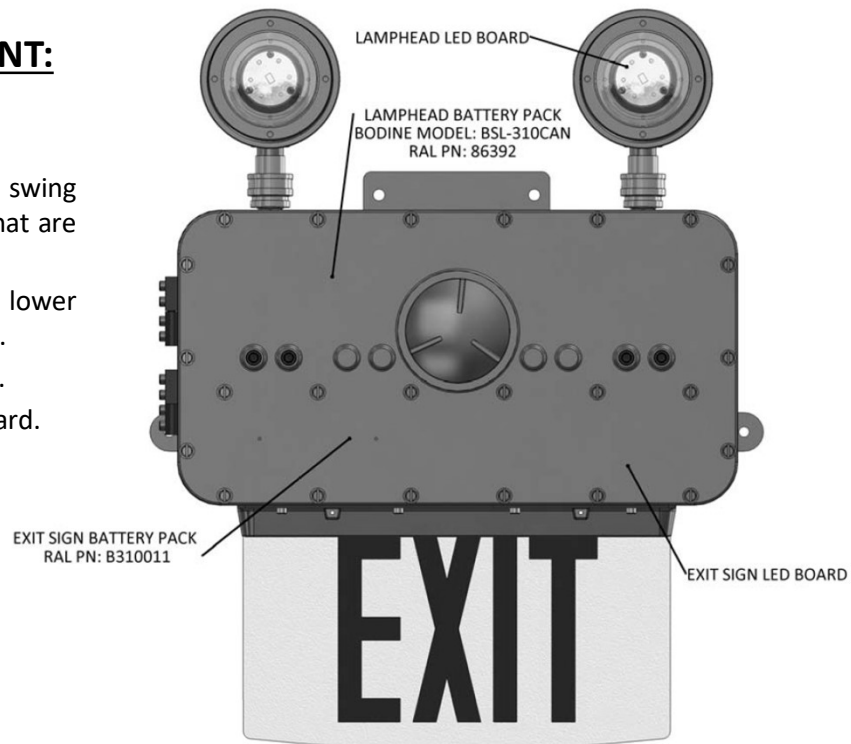

8500 Hansen Rd.
Houston, TX 77075 USA
XPEHIDS

Tel: 713-943-0340

Oct 2022

availinfra.com/rig-a-lite/

Rev. 3

INSTALLATION DATA SHEET

For fixtures with SD option only:

SELF-TESTING / SELF DIAGNOSTIC OPERATING INSTRUCTIONS

This unit meets the requirements of NFPA 101 for Periodic Testing of Emergency Lighting Equipment. It provides visual indication of unit malfunctions including:

Battery Fault
Charger Fault
Transfer Fault
Lamp Fault

SELF-TEST

The unit will perform a self-test and diagnostic function at least once every 30 days. The self-test will disable the charger and turn on the LEDs for 5 minutes to check the lamp load and battery. The test will be performed only if the battery is fully charged. If not, the test will automatically reschedule. The charger function is monitored continuously.

USER-TEST

A User-Test may be performed at any time the status display is continuous green. On initial power-up, it could take up to 72 hours for the status display to reach continuous green. With a fully charged battery, pressing the test switch momentarily will initiate a 30 second test. Pressing the test switch continuously for 4 seconds and releasing it will initiate a 90 minute test. Either test can be cancelled by pressing the test switch again for 1 second.

STATUS INDICATIONS

STATUS DISPLAY	FUNCTION	ACTION
Continuous Green	Battery in Float/Trickle Charge	None
Continuous Red	Battery High Charging	Wait for Green Status
Flashing Green	In Test Mode	Wait for Test to Complete
Alternate Red and Green	Insufficient Charge for User Test	Wait for Full Charge
Red One Blink ON / Pause	Transfer System Failure	Factory Service
Red Two Blinks ON / Pause	Battery Failure	Check Connections Replace Battery
Red Three Blinks ON / Pause	Charger Failure	Factory Service
Red Four Blinks ON / Pause	Lamp Failure	Check Remote Connection / Factory Service



8500 Hansen Rd.
Houston, TX 77075 USA
XPEHIDS

Tel: 713-943-0340

Oct 2022

availinfra.com/rig-a-lite/

Rev. 3