



INSTALLATION DATA SHEET XP SERIES



WARNING!

1. TO PREVENT RISK OF ELECTRICAL SHOCK, DEACTIVATE/DISCONNECT POWER SUPPLY BEFORE INSTALLING MAINTAINING OR RELAMPING FIXTURE.
2. TO REDUCE THE RISK OF FIRE OR EXPLOSION, DO NOT INSTALL WHERE THE MARKED OPERATING TEMPERATURE EXCEEDS THE IGNITION TEMPERATURE OF THE HAZARDOUS ATMOSPHERE(S).
3. THIS FIXTURE SHOULD BE INSTALLED BY QUALIFIED TECHNICIANS IN STRICT ACCORDANCE WITH THE NATIONAL ELECTRICAL CODE AND ANY LOCAL REQUIREMENTS.

INSTALLATION:

1. Before installing, make sure that the circuit is deactivated.
2. This unit is furnished completely assembled. Before installing, check the fixture label to insure correct voltage and frequency.

OPERATIONAL DATA:

Operate this fixture at its rated voltage. See fixture label for data. To receive the full benefit of rated lamp output and to prolong ballast life, it is essential that voltage supply to the fixture be maintained within the following limits:

NOMINAL VOLTAGE	APPLIED VOLTAGE RANGE	
	MINIMUM	MAXIMUM
120	110	125
220	205	232
236	220	250
277	255	290

MAINTENANCE:

1. Although no routine maintenance is required to keep this fixture functional, it should be checked periodically to ensure that it is working properly and to look for external damage.
2. For optimum performance, keep light transmission parts of the fixture clean. Any commercial glass cleaner can be used to clean the glass tubes.
3. To relamp, disconnect supply circuit. Remove the cover on either side of the fixture. Loosen lampholder bracket screws. Twist and remove lampholder bracket. Withdraw old lamp and insert new lamp in opposite lampholder. Replace lampholder into position on the lamp. Twist slightly to place lampholder bracket under screw heads and tighten screws. Replace cover.
4. An optional stainless steel wire guard, polycarbonate shield or both can be installed to protect the PYREX tubes. Refer to our catalog or www.rigalite.com for more information.
5. In the event of PYREX tube breakage, it will be necessary to replace the damaged unit with a factory sealed housing assembly in order to maintain fixture integrity. Refer to our catalog or www.rigalite.com for more information.
6. when replacing the ballast, it should be a Class P type offering thermal protection.

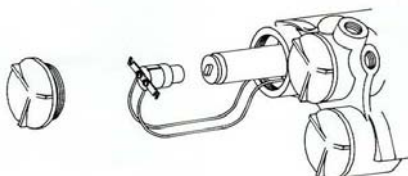

INSTALLATION DATA SHEET XP SERIES



Dummy (non-powered) end lowers for relamping clearance which is required when fixtures are mounted in close proximity. Flexible mounting provides free swing and impact protection.

1. Splice Box/Fixture Hanger
2. Flexible Pendant Hanger
3. Union
4. Rigid Support
5. Support Hook

Note: Leave extra links to support fixture in relamping positions.

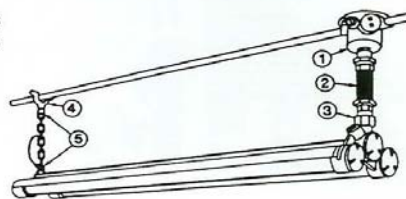

Dummy (non-powered) end lowers for relamping clearance which is required when fixtures are mounted in close proximity.

1. Splice Box/Fixture Hanger
2. Swivel Hanger
3. Union
4. Rigid Support
5. Support Hook
6. Conduit Nipple

Note: Leave extra links to support fixture in relamping position.



Rigid mounted — for installations where relamping can be accomplished without lowering dummy end.

1. Splice Box/Fixture Hanger
2. Union
3. Rigid Support

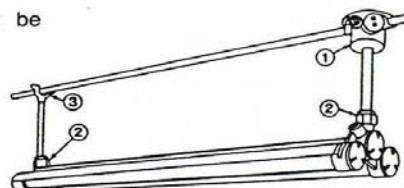

WALL/CEILING MOUNT KIT

Part Number 53041

Includes 2 brackets, 2 hex head pipe thread screws, 1 safety chain and assorted screws.

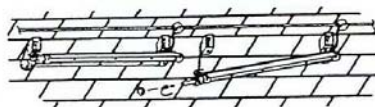

DROP MOUNT KIT

Part Number 53037

Includes 2 beam clamps, 2 universal shock mount assemblies, 1 eye bolt, 1 safety cable and assorted screws.

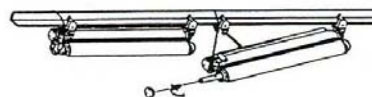

BEAM CLAMP MOUNT KIT

Part Number 53035

Includes 2 beam clamps, 2 stud hex mounts, 1 eye bolt, 1 safety cable and assorted screws.

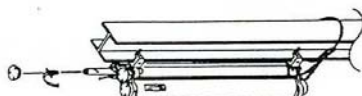

SHOCK MOUNT KIT

Part Number 53036

Includes 2 shock mount assemblies, 2 beam clamps, 1 eye bolt, 1 safety cable and assorted screws.

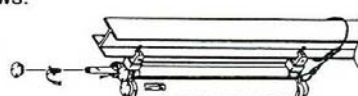

INSTALLATION DATA SHEET XP SERIES

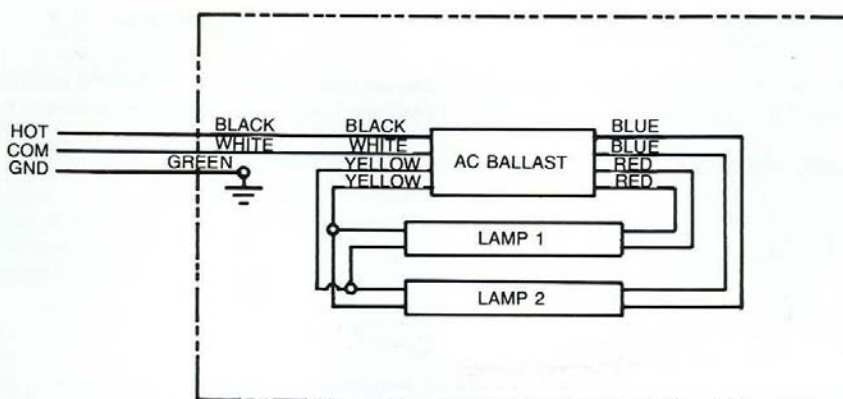

Wiring Diagram

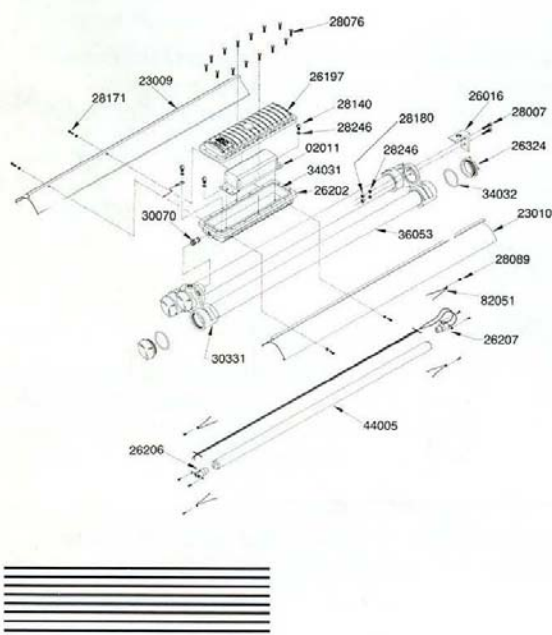

Part No.	Description	Weight	List Price
10128	SAFETY CABLE	-	32.84
12044	GRIP, CORD 1/2 HUB, 375-500	.3	16.44
12187	TUBE, GLASS 2"	2.6	194.52
23009	REFLECTOR, LEFT SIDE 4" LOOKING FROM WIRE END	4.5	64.79
23010	REFLECTOR, RIGHT SIDE 4" LOOKING FROM WIRE END	4.5	64.52
23110	REFLECTOR, RIGHT SIDE 3 LAMP 4 FT	7.06	93.16
23109	REFLECTOR, LEFT SIDE 3 LAMP 4 FT	7.09	96.60
23012	REFLECTOR, LEFT SIDE 2" LOOKING FROM WIRE END	2.2	64.89
23013	REFLECTOR, RIGHT SIDE 2" LOOKING FROM WIRE END	2.2	67.32
26016	BRACKET, MOUNTING ANGLE	.5	32.58
26017	HOUSING ASSY 4"	17.0	605.48
26003	HOUSING ASSY 3 LAMP 4 FT	18.0	551.49
26074	ROCK JUNCTION 4 LAMP	2.2	80.30
26018	BRACKET, LAMPHOLDER (800, 1800)	.1	5.48
26027	BRACKET, LAMPHOLDER (430)	.1	5.48
26029	STUD, HEX MOUNT	.2	5.48
26188	HOUSING ASSY 3"	11.4	546.21
26197	BALLAST HOUSING TOP	7.0	266.58
26202	BALLAST HOUSING BOTTOM	8.0	262.88
26206	LAMPHOLDER ASSY 18" LEAD (800, 1500)	2	13.70
26207	LAMPHOLDER & WIREWAY ASSY (800, 1500-4)	.4	27.40
26211	BEAM CLAMP	.8	21.90
32087	UNION WP 1/2 MALE/FEMALE	.1	28.14
30005	PLUG PIPE RECESSED 3/4 NPT	.02	8.25
30342	BRACKET END 4 LAMP	3.40	79.67
30305	NIPPLE HEX 1/2 - 1/4 NPT UNF 4 LAMP	.1	30.22
26249	LAMPHOLDER & WIREWAY ASSY (430-4)	.4	27.40
26263	LAMPHOLDER & WIREWAY ASSY (800, 1500-2)	.5	30.14
26294	LAMPHOLDER ASSY 18" LEAD (430)	.1	23.70
26295	LAMPHOLDER & WIREWAY ASSY (430-2)	.3	24.66
26324	COVER, SCREW CAP, NO LOGO	.8	24.98
26007	SCREW, HEX HD	.1	5.48
26076	SCREW, HEX HD	.1	5.48
26089	SCREW, PAN HD, SS	.1	5.48

Part No.	Description	Weight	List Price
26140	SCREW, HD HD, SS	.1	5.48
26171	SCREW, ALLEN HD, SS	.1	5.48
26180	NUT, HEX HD	.1	5.48
26203	SCREW, SO HD	.1	5.48
26099	BOLT, EYE	.2	5.48
26240	WASHER, SPLIT LOCK	.1	5.48
26246	WASHER, SPLIT LOCK, SS	.1	5.48
26297	SCREW, HEX HD	.1	5.48
30070	NIPPLE 1/2 X 1-1/2 ALUMINUM	.1	5.48
30030	END FITTING 2 HUB (OPPOSITE END)	2.5	104.11
30321	END FITTING 3 HUB (WIRE END)	4.0	189.86
30343	PLUS, RECESSED ALUMINUM	.1	5.48
30801	FUSE SA (FOR 12 & 24VTRIS)	.1	45.50
30003	FUSE 4A (FOR 32V FIXTURE ONLY)	.1	45.50
30003	BLOCK FUSE	.1	30.89
32036	BLOCK FUSE END SECTION	.1	5.48
34031	GASKET, BALLAST HOUSING/FT	.1	5.48
34032	GASKET, COVER SEAL	.1	5.48
34033	GASKET, GLASS TUBE SEAL	.1	5.48
30053	TUBE, GLASS 48"	5.1	213.70
32002	SHOCK MOUNT ASSY (XPRND) (EACH)	1.5	37.67
53017	SHOCK MOUNT W/BEAM CLAMP (XPRND) (EACH)	2.0	125.55
53025	MOUNTING KIT XP- BEAM CLAMPS	2.8	86.71
53036	SHOCK MOUNT KIT XP SERIES	2.8	264.79
53037	UNIVERSAL SHOCK MOUNT KIT	5.3	146.89
53041	WALL MT KIT	5.0	126.77
60008	SEALING COMPOUND 2 LB KIT	2.0	204.33
70040	LAMPHOLDER (AWW D.C.) TUBE	.1	32.88
70041	LAMPHOLDER (AWW D.C.) FIRED	.1	32.88
80251	LAMP GUIDE	.1	5.48
80251	POLYCARBONATE SHIELD 2" (XP2-2L-G)	.7	117.60
80602	POLYCARBONATE SHIELD 4" (XP4-2L-G)	1.3	125.90
80603	POLYCARBONATE SHIELD 4" 3 LAMP (XP4-3L-G)	1.9	136.75
80320	WIRE GUARD (STAINLESS STEEL) 4" (XP4-2L-G)	2.1	217.00
80345	WIRE GUARD (STAINLESS STEEL) 4" 3 LAMP (XP4-3L-G)	3.5	233.60
80321	WIRE GUARD (STAINLESS STEEL) 2" (XP2-2L-G)	1.1	200.00